

1x **33** BARANDA - 1:20

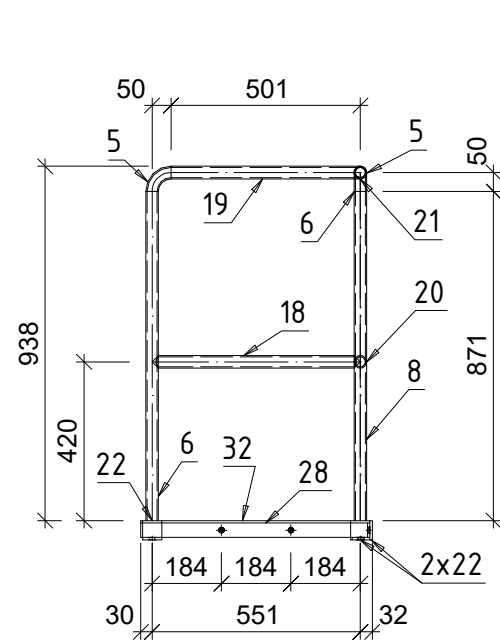

1x **34** BARANDA - 1:20

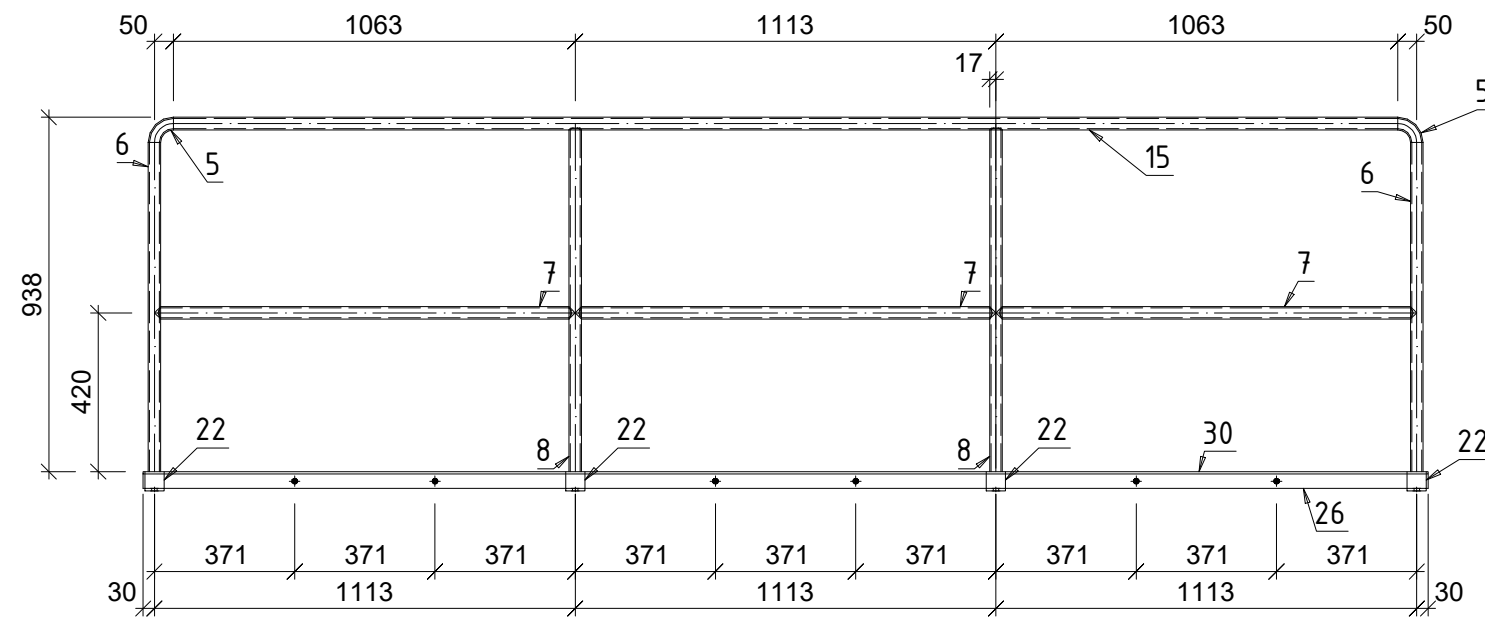
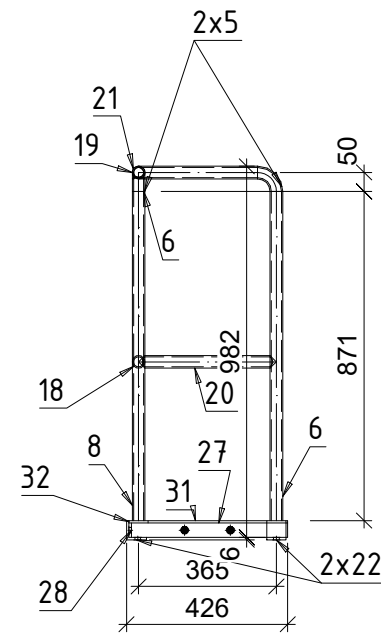

1x **37** BARANDA - 1:20

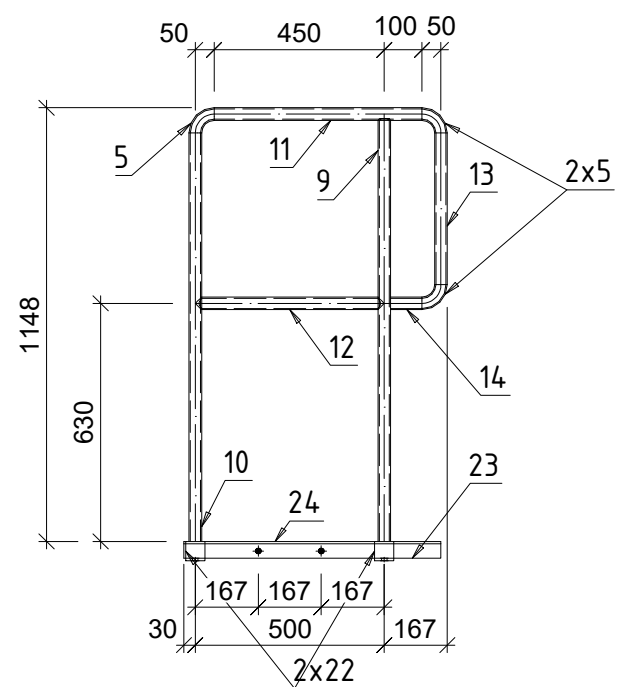

1x **35** BARANDA - 1:20

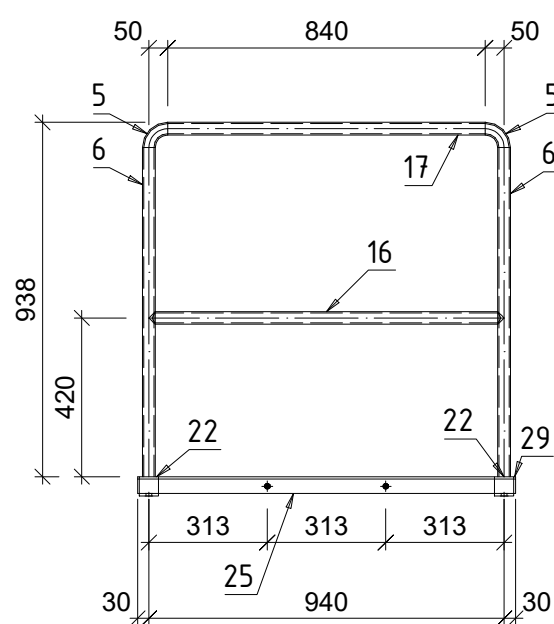

1x **36** BARANDA - 1:20

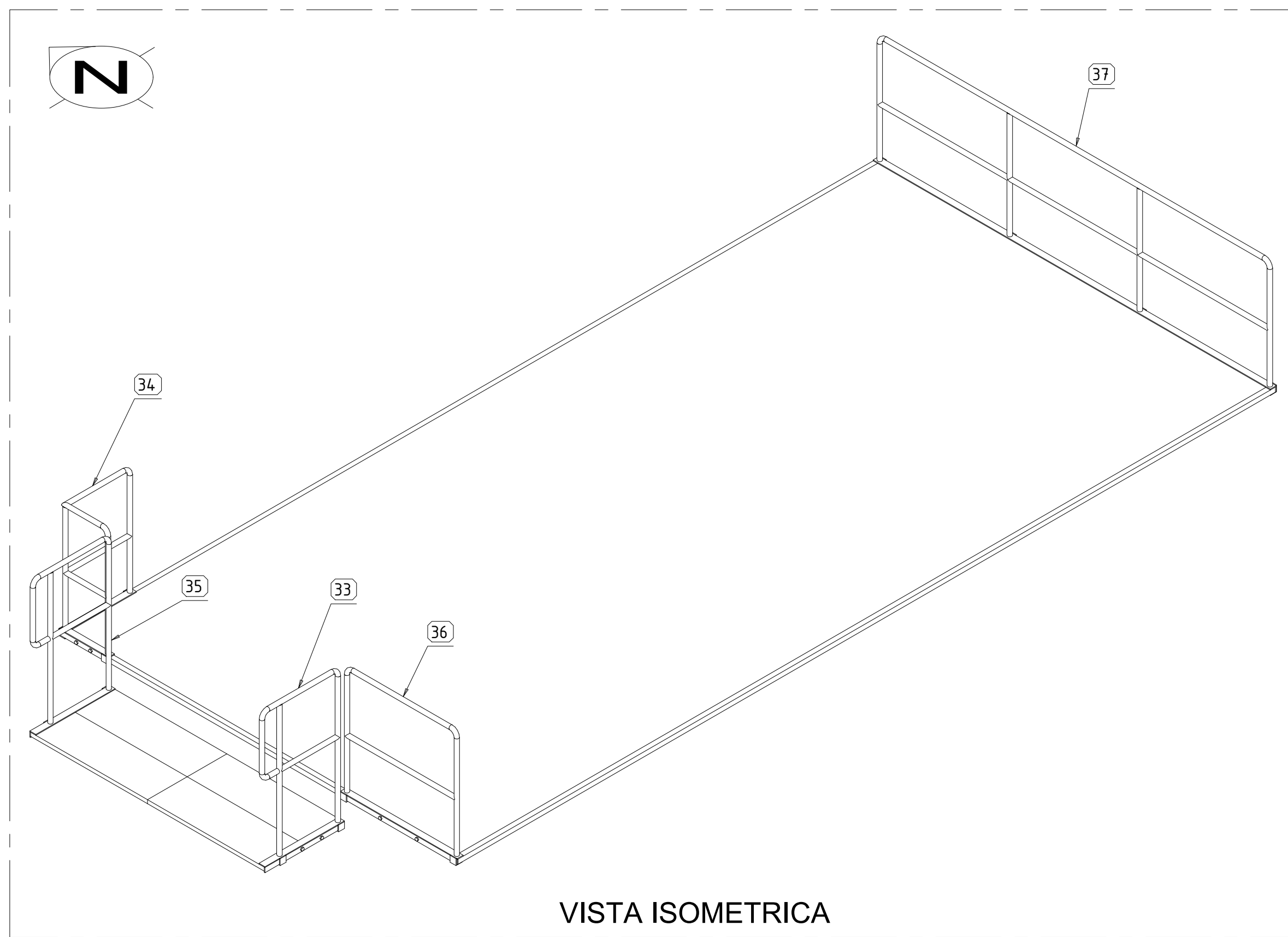

VISTA ISOMETRICA

NOTAS :

Mark	Quantity	Description	Length	Grade	Part weight	Total weight
33	1	PipeSTD				
9	1	PipeSTD	199	Stainless Steel 304	2.85	2.85
10	1	PipeSTD	109	Stainless Steel 304	2.76	2.76
24	1	PL 6.35x50.8x680	680	Stainless Steel 304	1.75	1.75
11	1	PipeSTD	55	Stainless Steel 304	1.4	1.4
23	1	PL 6.35x38.1x680	680	Stainless Steel 304	1.32	1.32
12	1	PipeSTD	50	Stainless Steel 304	1.27	1.27
13	1	PipeSTD	49	Stainless Steel 304	1.02	1.02
22	2	PL 50.8x50.8x52.8	52.8	Stainless Steel 304	0.67	1.34
14	1	PipeSTD	9	Stainless Steel 304	0.21	0.21
5	3	PipeSTD	19	Stainless Steel 304	0.2	0.6
38	4	M12.7x31.75	32		0.14	0.56
One assembly weight:					15.09	15.09
34	1	PipeSTD				
8	1	PipeSTD	199	Stainless Steel 304	2.32	2.32
6	2	PipeSTD	83	Stainless Steel 304	2.22	4.44
32	1	PL 6.35x50.8x606.35	606.35	Stainless Steel 304	1.5	1.5
18	1	PipeSTD	59	Stainless Steel 304	1.4	1.4
19	1	PipeSTD	58	Stainless Steel 304	1.32	1.32
28	1	PL 6.35x38.1x606.35	606.35	Stainless Steel 304	1.17	1.17
31	1	PL 6.35x50.8x20	20	Stainless Steel 304	1.02	1.02
20	1	PipeSTD	36	Stainless Steel 304	0.93	0.93
21	1	PipeSTD	33	Stainless Steel 304	0.84	0.84
27	1	PL 6.35x38.1x20	20	Stainless Steel 304	0.81	0.81
22	3	PL 50.8x50.8x52.8	52.8	Stainless Steel 304	0.67	2.01
5	2	PipeSTD	19	Stainless Steel 304	0.2	0.4
38	3	M12.7x31.75	32		0.14	0.42
39	4	M12.7x25.4	25		0.13	0.52
One assembly weight:					19.11	19.11
35	1	PipeSTD				
9	1	PipeSTD	199	Stainless Steel 304	2.85	2.85
10	1	PipeSTD	109	Stainless Steel 304	2.76	2.76
24	1	PL 6.35x50.8x680	680	Stainless Steel 304	1.75	1.75
11	1	PipeSTD	55	Stainless Steel 304	1.4	1.4
23	1	PL 6.35x38.1x680	680	Stainless Steel 304	1.32	1.32
12	1	PipeSTD	50	Stainless Steel 304	1.27	1.27
13	1	PipeSTD	49	Stainless Steel 304	1.02	1.02
22	2	PL 50.8x50.8x52.8	52.8	Stainless Steel 304	0.67	1.34
14	1	PipeSTD	9	Stainless Steel 304	0.21	0.21
5	3	PipeSTD	19	Stainless Steel 304	0.2	0.6
38	4	M12.7x31.75	32		0.14	0.56
39	4	M12.7x25.4	25		0.13	0.52
One assembly weight:					15.79	15.79
36	1	PL 6.35x50.8x1000	1000	Stainless Steel 304	2.58	2.58
29	1	PL 6.35x50.8x1000	99	Stainless Steel 304	2.4	2.4
16	1	PipeSTD	98	Stainless Steel 304	2.4	2.4
6	2	PipeSTD	83	Stainless Steel 304	2.22	4.44
17	1	PipeSTD	86	Stainless Steel 304	2.14	2.14
25	1	PL 6.35x38.1x1000	1000	Stainless Steel 304	1.94	1.94
22	2	PL 50.8x50.8x52.8	52.8	Stainless Steel 304	0.67	1.34
5	2	PipeSTD	19	Stainless Steel 304	0.2	0.4
38	4	M12.7x31.75	32		0.14	0.56
39	6	M12.7x25.4	25		0.13	0.78
One assembly weight:					15.79	15.79
37	1	PL 6.35x50.8x3400	3400	Stainless Steel 304	8.77	8.77
30	1	PL 6.35x50.8x3400	326	Stainless Steel 304	8.26	8.26
15	1	PipeSTD	326	Stainless Steel 304	6.58	6.58
26	1	PL 6.35x38.1x3400	3400	Stainless Steel 304	2.84	2.84
7	3	PipeSTD	158	Stainless Steel 304	2.22	6.66
8	2	PipeSTD	98	Stainless Steel 304	2.32	4.64
6	2	PipeSTD	83	Stainless Steel 304	2.22	4.44
22	4	PL 50.8x50.8x52.8	52.8	Stainless Steel 304	0.67	2.68
5	2	PipeSTD	19	Stainless Steel 304	0.2	0.4
38	4	M12.7x31.75	32		0.14	0.56
39	6	M12.7x25.4	25		0.13	0.78
One assembly weight:					45.62	45.62
Combined Total					110.69	110.69

REV.	Date	Description	BY
A	19/02/2026	EMITIDO PARA REVISIÓN	J.C.G

esentia
Perforaciones, Pulido y Montajes

N° Proyecto	OT 60029293	Título	BARANDAS PARA TARIMA EN AUDITORIO SEGUNDO PISO EDIF. DE ADMINISTRACION	Codigo Doc.	N/A
Planta:	N/A	Area:	50		
Diseñador:	ESENTIA	N° de Diseñador:	P1PP50-64-3-	Tipo de Documento:	ESTRUCTURAL
				Especialidad:	MECANICO
N° Documento de Ref.	-	N° de Esentia:	P1PP50-64-3-	Pagina N°	1/2
Escala:	1:20,1:25	Fecha	19/02/2026	Soldadura:	By Manufacturer
Dibujó:	YELTSYN GARCIA	Fecha	19/02/2026	Grado:	304
Revisó:	JORGE CARAZO	Fecha	19/02/2026	Revestimiento:	Stainless Steel